

Free Standing Hand Operated Deluge Shower & Platform Operated Eye Wash

Enware's emergency safety showers assist in the rapid flushing of contaminants from the body with a deluge of flushing fluid and eye/face wash units help to flush contaminants and irritants from eyes and facial area.

Designed and manufactured in Australia. Stainless steel construction provides superior durability and reliability.

EP1020



FEATURES

- Independently tested for compliance to ANSI Z358.1 and AS4775
- Freestanding for stand-alone operation
- Stainless steel pipe work & stay-open ball valve
- Stainless steel 200mm (8") shower head assembly
- Stainless steel impeller with drenching spray pattern
- Stainless steel pull rod activated shower
- Balanced simultaneous operation
- Self-draining design reduces Legionella risk, particularly in tepid water applications
- Eye/face wash features "Vertech™ Technology" where dedicated eyewash and independently angled face wash streams deliver optimum coverage
- Zero velocity apex point provides more comfort and control for effective cleansing of eyes
- High visibility yellow powder coated push handle and foot pedal

ADDITIONAL OPTIONS

- Audio/Visual alarms for alerts
- Flow pressure & proximity switches to activate alarms and lights
- Proximity switches an alternative to flow switches
- Thermal relief valve removes built-up hot water
- Insulation of pipe work to moderate water temperature build up
- Anti-freeze valve for cold weather climates to help prevent water freezing
- Pressure relief valve
- NPT Flange connectors
- Custom manufacturing & design
- Signage compliant to AS1319

Product Codes

EP1020	Standard Brushed Stainless Steel Finish
EP1020GR	Green Powder Coated Finish
EP1020OR	Orange Powder Coated Finish
EP1020YE	Yellow Powder Coated Finish
EP1020WH	White Powder Coated Finish



Technical Information

Inlet Connection	25 mm (1") BSP
Water Supply Line Size	DN25 mm (1") Nominal Size Supply piping shall be adequately sized to meet flow requirements
Minimum Performance Requirements	210 kPa Caution should be taken when pressure exceeds 550 kPa (80 psi)
Minimum Flow Requirements	75.7 lpm (20 US gpm)
Minimum Working Pressure for low pressure installations *	40 kPa (5.7 psi)
Waste Water Outlet Size	DN 40 mm (1 1/2") OD
Mounting Base Plate Size	150 x 150 mm (5 9/10" x 5 9/10") with 4 Bolt Holes 11 mm (7/16")
Weight	approx. 10.6kg
Dimensions	1190 x 410 x 360 mm

Installation of emergency showers, eye and eye/face wash equipment shall be in accordance with AS/NZS4775-2007 or ANSI Standard Z358.1 - whichever is applicable to the installation. Enware Australia advises:

- Due to ongoing Research and Development, specifications may change without notice.
- Component specifications may change on some export models.

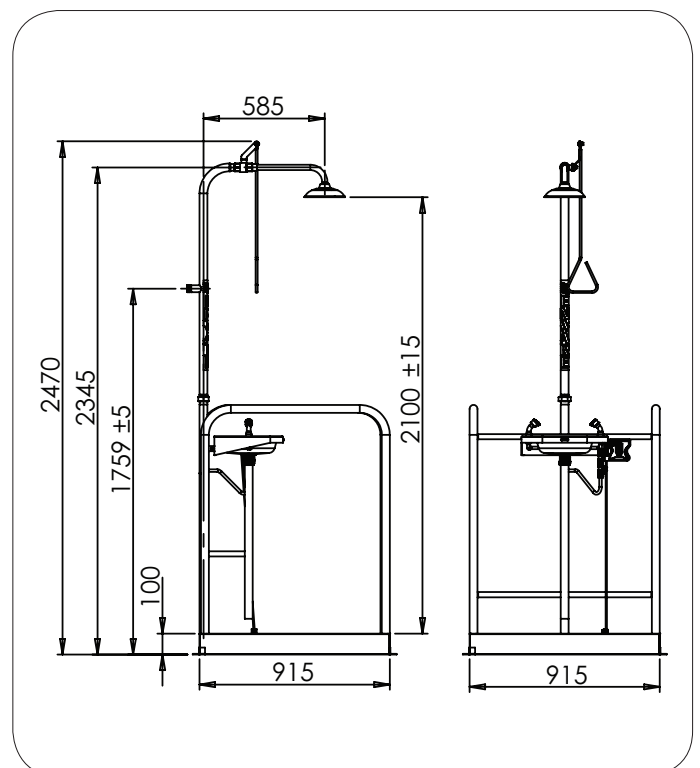

Version: May 18

Call 1300 369 273
www.enware.com.au

Enware Australia Pty Limited
9 Endeavour Rd Caringbah NSW 2229 Australia
Ph: 02 8536 4000 info@enware.com.au



A range of spare parts are available to maintain equipment and replacement of damaged parts.

Description	Order Code
1 Eye and Eye/Face Wash Frame Only	ESPE815
2 Push Handle to suit Eye and Eye/Face Washes	ESPE010
3 Pull handle to activate shower	ESPE009
4 Shower arm and rose	ESPE005
5 Bowl only	ESPE008
9 Eye Wash Aerator and Washer	ESPE015
10 Eye wash outlet includes dustcovers & aerators (pair)	ESPE016

